

Set up and enable your camera in Google Chrome



Your camera must be set up before performing your face registration.

It is very important that you do not use or select a virtual or IR camera, such as **Snapcamera, DroidCam, Iriun webcam, etc.**

- 1 Go to the three dots menu located in the upper right corner.
- 2 Click on "**Settings**".

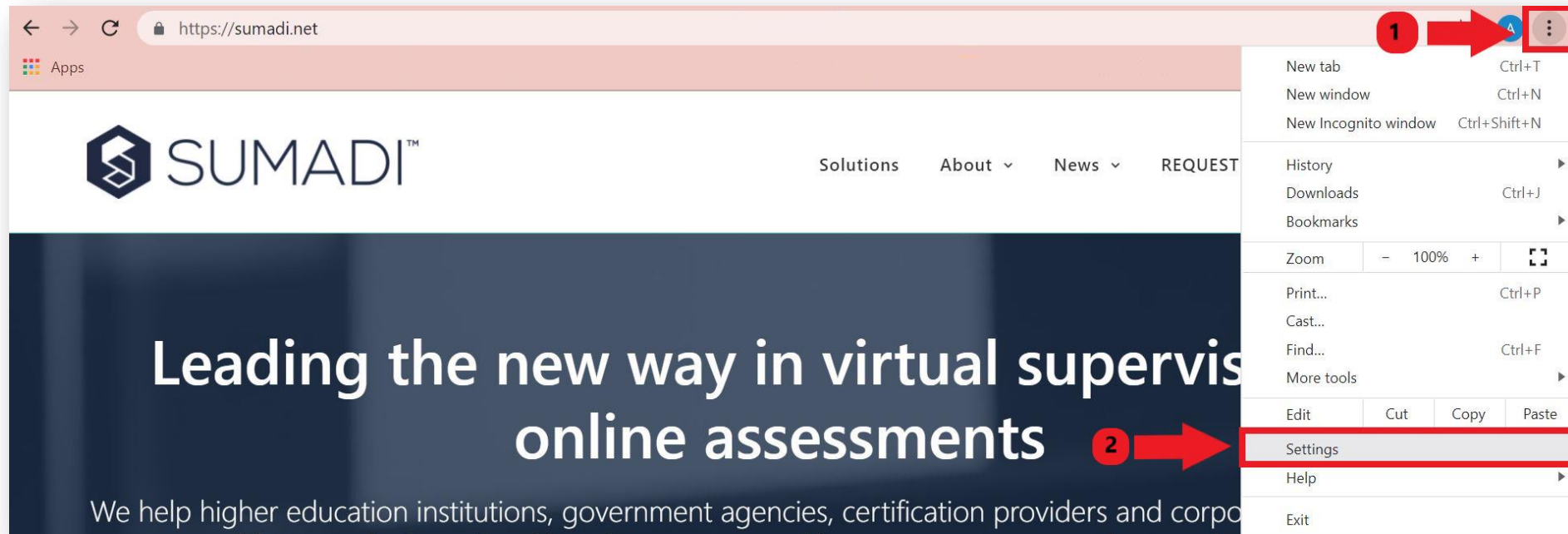

- 3 Search for the "Privacy and Security" section and click on the "Site Settings" option.

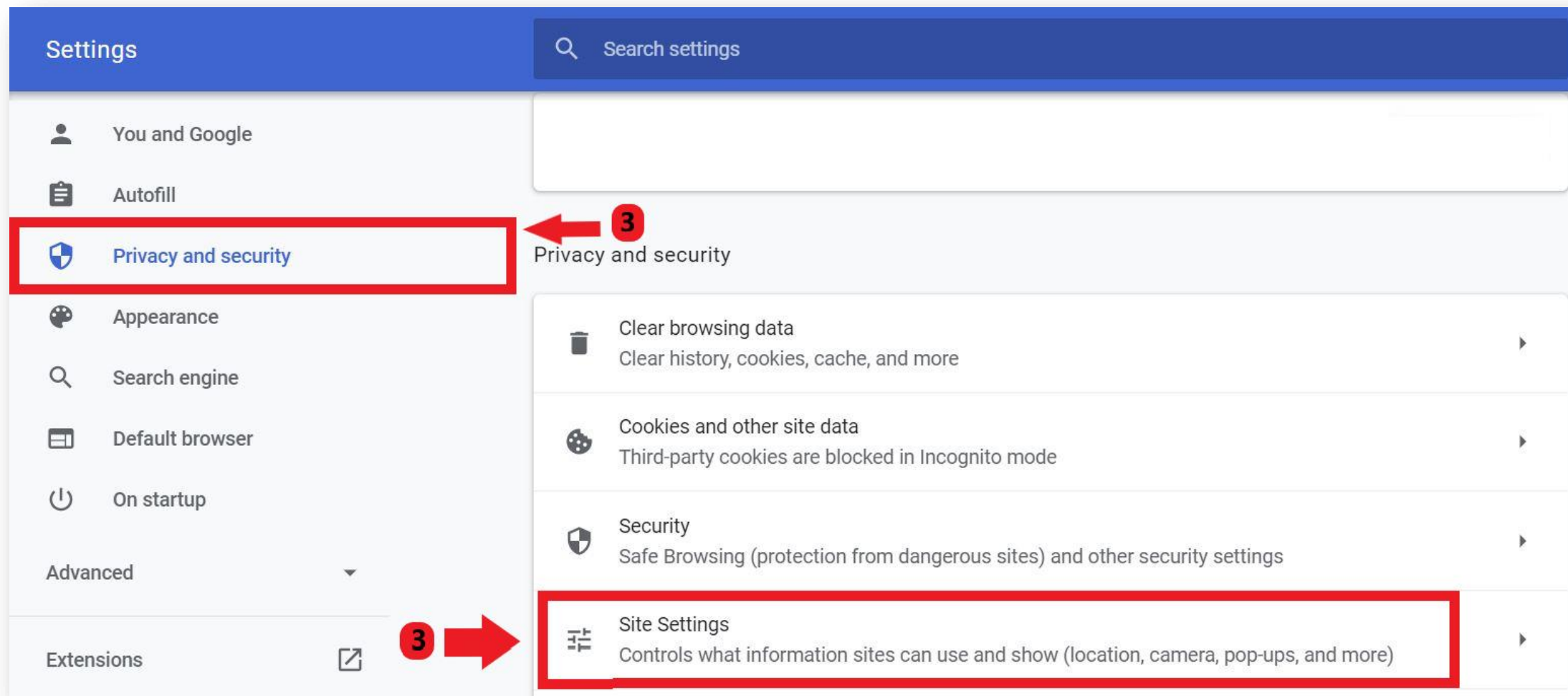

4 Search for the "Camera" section.

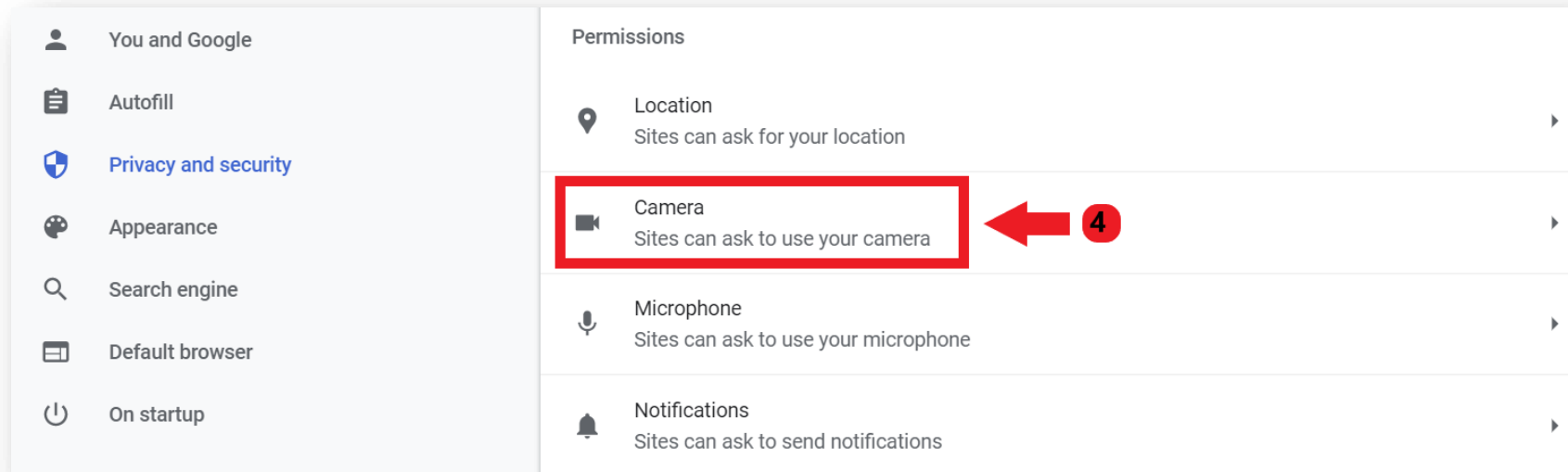

5 In the available cameras' menu, select your computer's built-in/integrated camera (make sure it's not a virtual or IR one).



If you have not given SUMADI™ permissions to access or disable the camera, a modal window will display asking you to enable it.

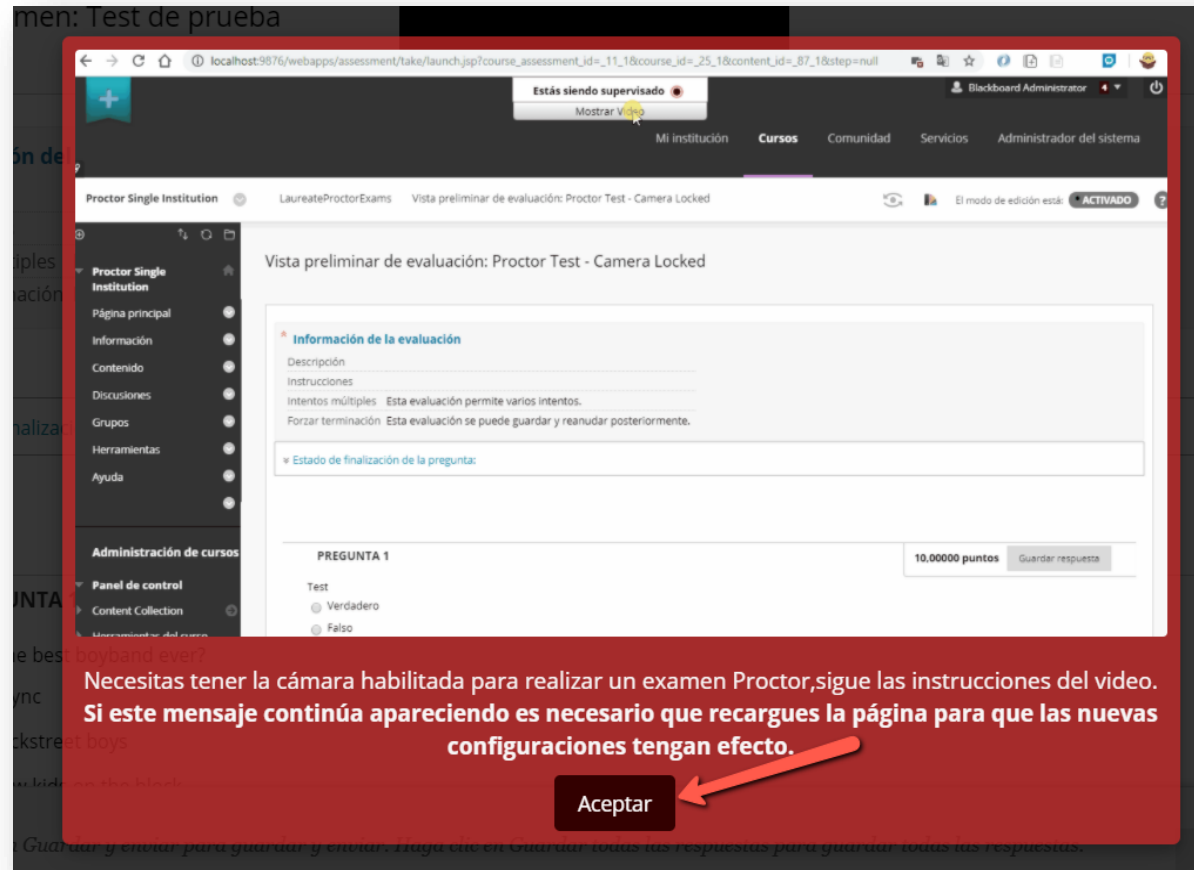

The screenshot shows a web browser window displaying a Proctor exam interface. At the top, a notification bar reads "Estás siendo supervisado" (You are being supervised) with a camera icon and a "Mostrar V" button. Below this, the page title is "Vista preliminar de evaluación: Proctor Test - Camera Locked". The main content area shows "Información de la evaluación" (Evaluation information) with fields for "Descripción", "Instrucciones", "Intentos múltiples" (This evaluation allows multiple attempts), and "Forzar terminación" (This evaluation can be saved and resumed later). Below this is a section for "PREGUNTA 1" (Question 1) with a "10,0000 puntos" (10,0000 points) value and a "Guardar respuesta" (Save answer) button. A red modal window is overlaid on the bottom half of the page, containing the text: "Necesitas tener la cámara habilitada para realizar un examen Proctor, sigue las instrucciones del video. Si este mensaje continúa apareciendo es necesario que recargues la página para que las nuevas configuraciones tengan efecto." (You need to have the camera enabled to take a Proctor exam, follow the instructions in the video. If this message continues to appear, it is necessary that you reload the page so that the new configurations take effect.) An "Aceptar" (Accept) button is at the bottom of the modal, with a red arrow pointing to it.

1 Click on the camera icon that will appear at the top right corner of the address search bar.

2 Then click on the "enable camera access" option.

3 Refresh the page, and the video will automatically appear, and you will be able to use the camera to continue with your exam.

